

Install Speakers

VX 8.2-WH

8" Dual Concentric Full Range Loudspeaker with Low Frequency Driver for Portable and Installation Applications (White)

- Full range multi-purpose sound reinforcement loudspeaker for portable and installation applications
- 200 Watts continuous, 800 Watts peak power
- 8" Dual Concentric full range driver for point source phase coherence
- 8" low frequency driver for extended bass response
- Precise 90° dispersion for optimum coverage and forward projection
- Ideal for FOH, floor monitor and side fill applications
- Vented and internally braced plywood enclosure
- Finished with hard wearing semi matt white paint
- Rugged powder coated perforated steel mesh grille
- Blanking plate for optional VTH pole mount
- Optional horizontal mounting yoke (available separately)
- Integrip handles ergonomically integrated into top and bottom of cabinet
- Neutrik* speakON NL4 and barrier strip connectors for input and link output
- 5-Year Warranty Program*
- Designed and engineered in the U.K.

The VX 8.2-WH is a new concept for this type of device, adding new capabilities to the range with its exceptional acoustic clarity, definition and all round acoustical performance. Boasting an exceptional performance-to-size ratio, VX 8.2 provides a compact, yet punchy and sonically articulate solution for medium scale performance sound reinforcement as well as high performance speech reproduction where clarity and vocal character are paramount. The versatile twin driver design and mounting options also make the VX 8.2-WH, due to acoustic matching with the wider range of VX Series models, perfectly capable components within much larger installations.



Dual Concentric Driver

The 800-Watt 200 mm (8") version of TANNOY's VX Series point source loudspeakers, VX 8.2-WH's constant directivity Dual Concentric drive unit technology ensures high power output with high sensitivity and exceptional efficiency. VX 8.2-WH delivers precise 90° dispersion for optimum coverage, exceptional forward gain plus the added benefit of improved low-mid extension from the twin driver configuration. An additional 200 mm (8") low frequency driver is employed to provide extended bass response.

Install Speakers

VX 8.2-WH

8" Dual Concentric Full Range Loudspeaker with Low Frequency Driver for Portable and Installation Applications (White)

Performance Applications

VX 8.2-WH's trapezoidal enclosure design provides a multitude of placement options including: installed performance sound reinforcement, medium scale FOH, floor monitor, high SPL delay and and more. A blanking plate for optional VTH pole mounting is provided for placement atop a subwoofer in portable PA applications. An extensive range of optional VX 8.2 high performance steel mounting hardware (available separately) includes a horizontal yoke bracket, and Omnimount* spaced inserts for wall and ceiling installation. All hardware has been tested and certified for a greater than 5:1 safety ratio – giving installers complete peace of mind.



Construction

Finished in a hard wearing semi matt white paint, the vented and internally braced cabinet is constructed from 15 mm (5/8") plywood – and includes a rugged powder coated perforated steel mesh grille. Integrip handles ergonomically integrated into the top and bottom of cabinet make for easy transport. The rear panel connector plate carries Neutrik speakON* NL4 and barrier strip connectors for input and link connections to additional enclosures. VX 8.2-WH loudspeakers are optimized for use with LAB GRUPPEN amplifiers, or LAKE LM Series controllers. A full range of DSP settings to suit many configurations are provided for free download at tannoy.com.

You Are Covered

We always strive to provide the best possible Customer Experience. Our products are made in our own MUSIC Group factory using state-of-the-art automation, enhanced production workflows and quality assurance labs with the most sophisticated test equipment available in the world. As a result, we have one of the lowest product failure rates in the industry, and we confidently back it up with a generous 5-Year Warranty program.



Install Speakers

VX 8.2-WH

8" Dual Concentric Full Range Loudspeaker with Low Frequency Driver for Portable and Installation Applications (White)

Frequency Response Sensitivity 1 W / 1 m

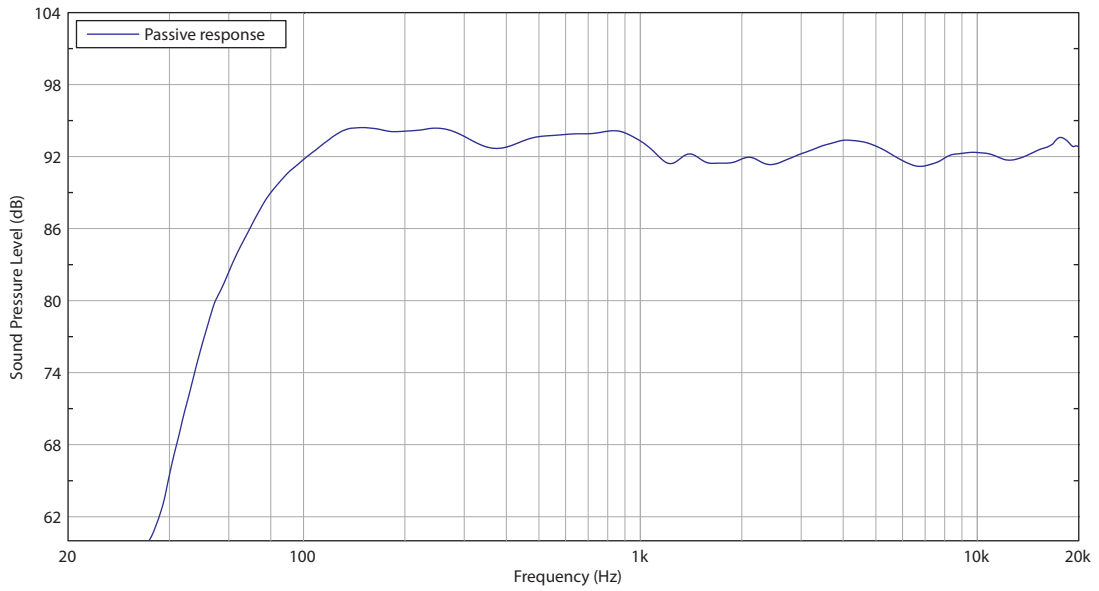

Impedance

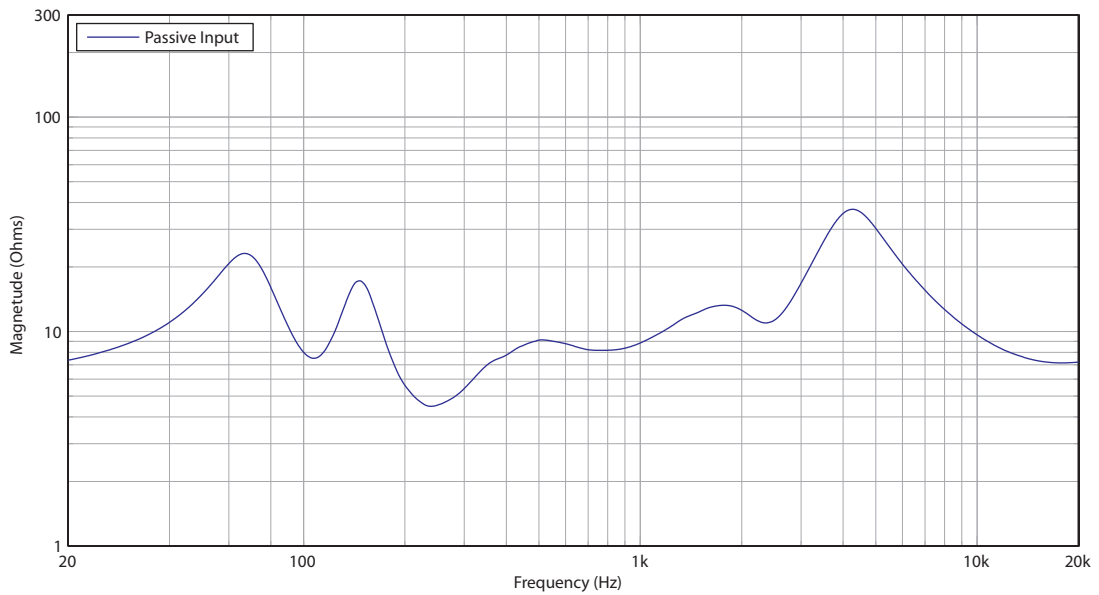

Install Speakers

VX 8.2-WH

8" Dual Concentric Full Range Loudspeaker with Low Frequency Driver for Portable and Installation Applications (White)

Horizontal Beamwidth

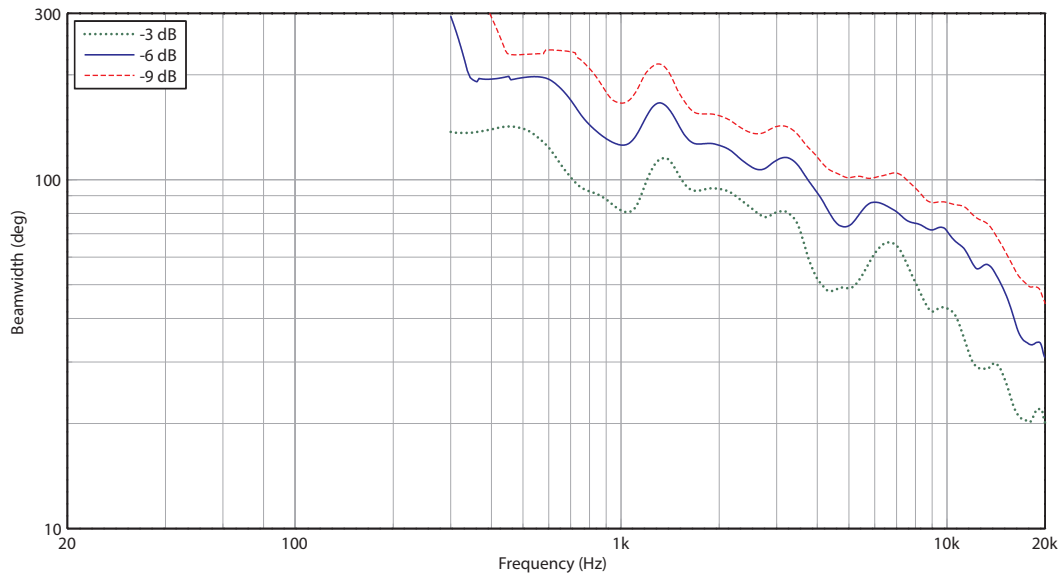

Vertical Beamwidth

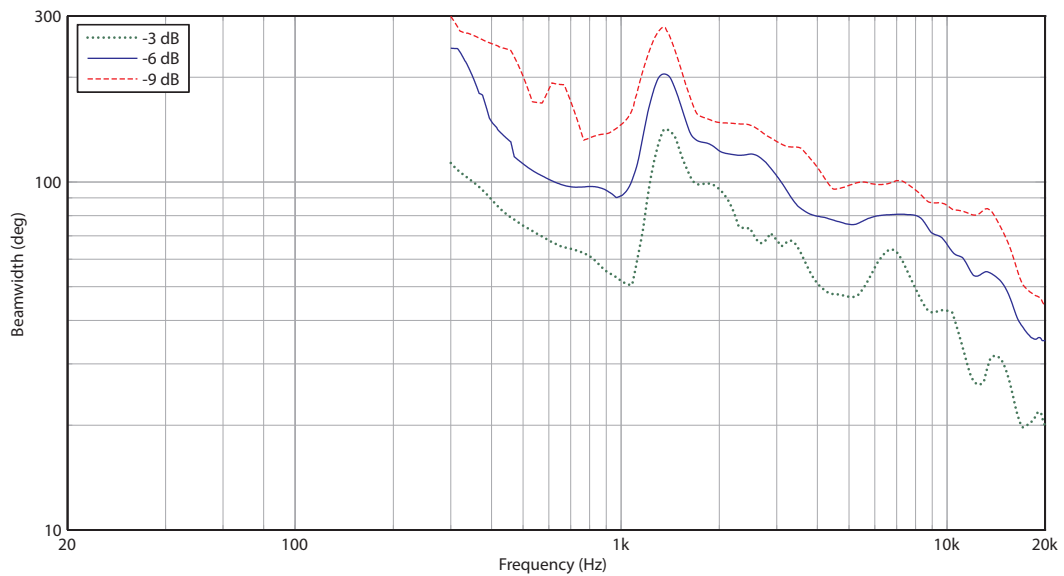

Install Speakers

VX 8.2-WH

8" Dual Concentric Full Range Loudspeaker
with Low Frequency Driver for Portable and
Installation Applications (White)

Horizontal Polar Plots

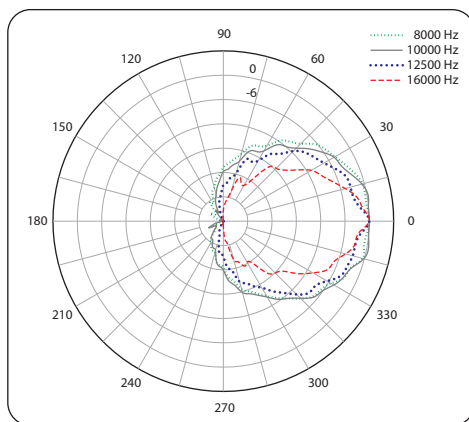
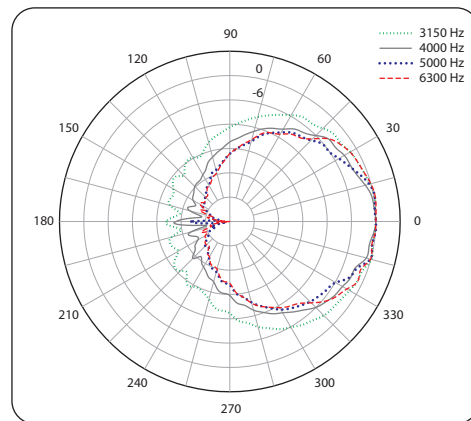
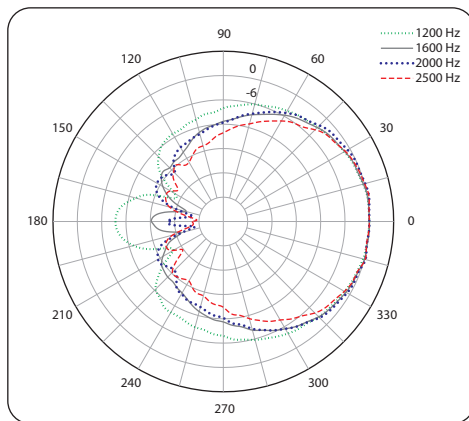
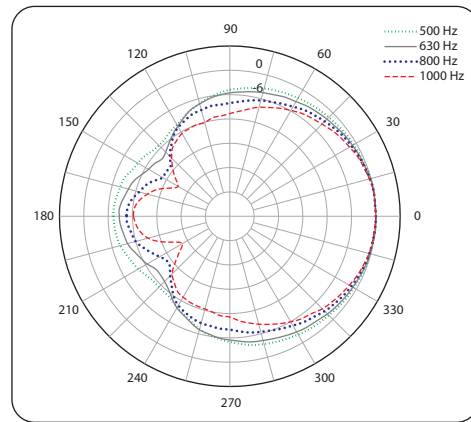
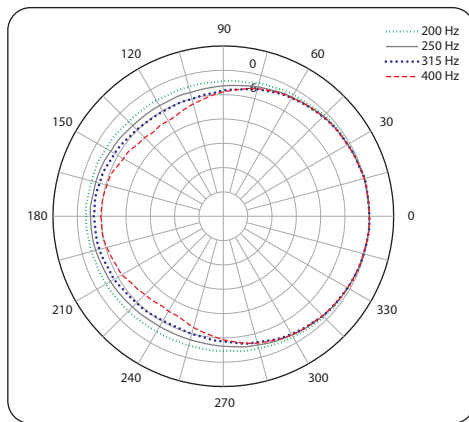

Install Speakers

VX 8.2-WH

8" Dual Concentric Full Range Loudspeaker
with Low Frequency Driver for Portable and
Installation Applications (White)

Vertical Polar Plots

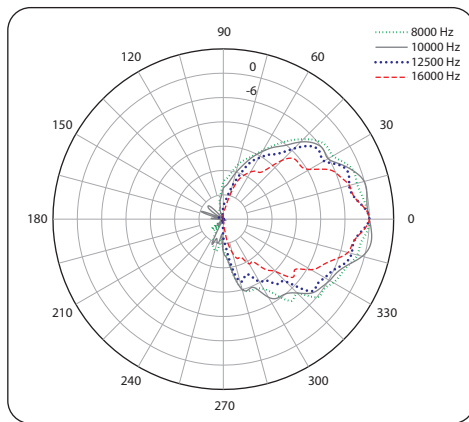
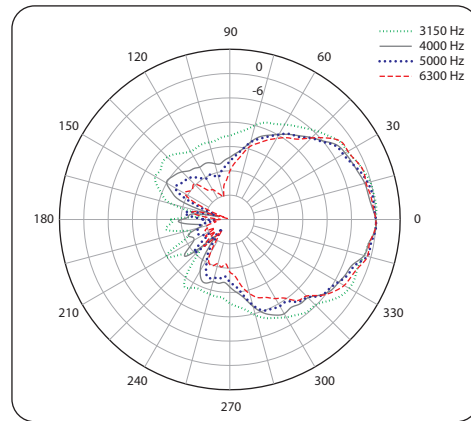
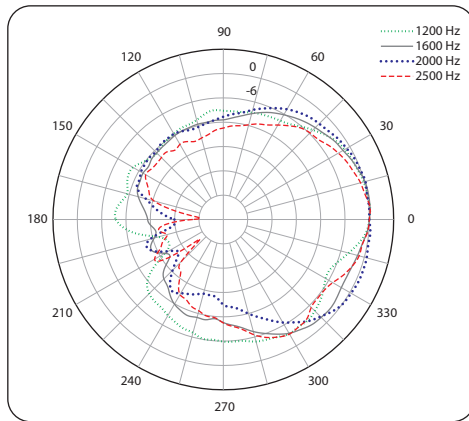
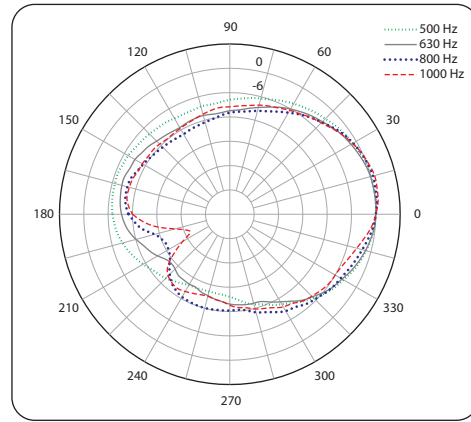
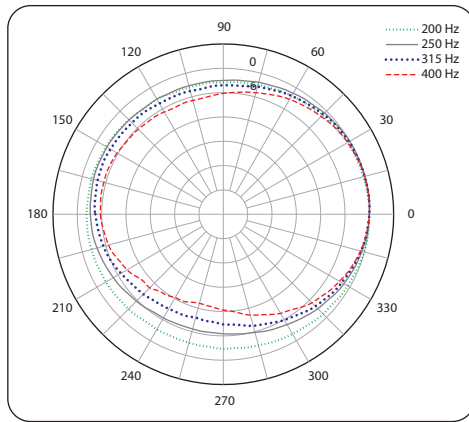

Install Speakers

VX 8.2-WH

8" Dual Concentric Full Range Loudspeaker with Low Frequency Driver for Portable and Installation Applications (White)

Dimensions

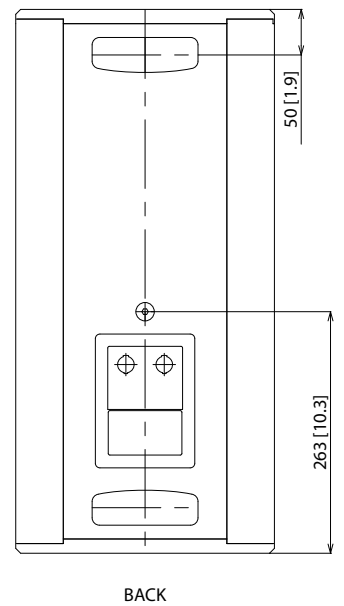
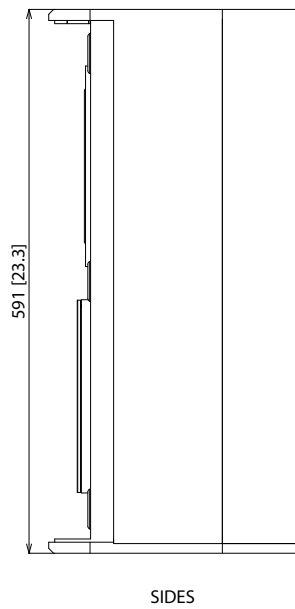
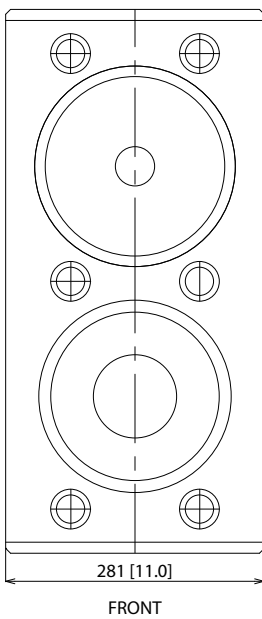
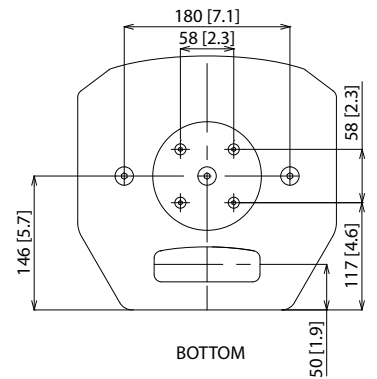
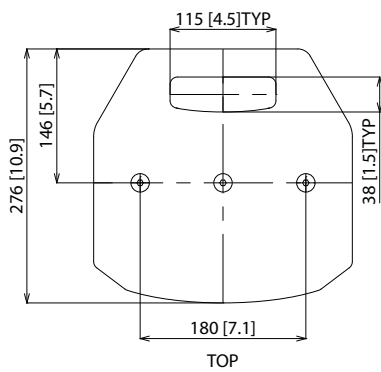

Install Speakers

VX 8.2-WH

8" Dual Concentric Full Range Loudspeaker with Low Frequency Driver for Portable and Installation Applications (White)

Technical Specifications

System

Frequency response	80 Hz - 35 kHz \pm 3 dB 60 Hz - 45 kHz -10 dB
Nominal dispersion	90° conical @ -6 dB point
Directivity factor (Q)	8.1
Directivity index (DI)	9.2
Power handling (IEC)	
Passive	200 W continuous, 800 W peak
Bi-amp	—
Sensitivity	93 dB (1 W @ 1 m)
Maximum SPL	
Passive	116 dB continuous, 122 dB peak
Bi-amp	—
Impedance	
Passive	8 Ω
Bi-amp	—
Crossover Type	Passive with dynamic HF protection
Components	1 x 8" (200 mm) LF driver 1 x 8" (200 mm) constant directivity Dual Concentric

Enclosure

Connectors	2x Neutrik speakON® NL4 1 x barrier strip terminals
Wiring	
Passive	Pins 1+ / 1- Input, Pins 2+ / 2- Link
Bi-Amp	—
Dimensions H x W x D	591 x 281 x 276 mm (23.3 x 11.1 x 10.9")
Net weight	14.8 kg (32.6 lbs)
Construction	15 mm (5/8") plywood, vented and internally braced
Finish	Semi matt black paint (white optional)
Grille	Powder coated perforated steel
Flying hardware	M10 x 4 flying inserts M10 x 2 yoke bracket inserts 2 x Integrip carrying handle Blanking plate for optional VTH pole mount

Accessories

Yoke Horizontal VX8.2
Yoke Horizontal VX8.2 - WH
Yoke Vertical VX8/VX8.2
Yoke Vertical VX8/VX8.2 - WH
VTH Top Hat

Install Speakers

VX 8.2-WH

8" Dual Concentric Full Range Loudspeaker
with Low Frequency Driver for Portable and
Installation Applications (White)

Architecture & Engineering Specifications

The loudspeaker shall consist of a 200 mm (8") full range, single point source Dual Concentric transducer and a 200 mm (8") bass transducer. The low and the high frequency elements of the Dual Concentric shall be combined by an internal passive crossover network operating at 1.5 kHz. An internal passive low-pass filter operating at 360 Hz shall limit midrange response of the bass transducer to prevent destructive cancellation.

Performance of the loudspeaker, without any external electronic control, shall meet or exceed the following criteria: Frequency response measured at 1 metre on axis with swept sine wave shall be 80 Hz – 35 kHz (-3 dB). Sensitivity shall be at least 93 dB (anechoic) 1 watt @ 1 metre and the loudspeaker shall be capable of producing a peak output level of 122 dB (anechoic) on axis at 1 metre. Dispersion shall be 90 degrees conical (-6 dB). The system shall have a nominal impedance of 8 ohms. Long-term power handling (EIA-426B) shall be 200 watts and recommended amplifier power shall be 400 watts.

The enclosure shall be an optimally tuned 25.3 litre vented enclosure of plywood construction. The enclosure shall be fitted with dual integral carrying handles, blanked off recess for optional pole-mount socket installation, 4 x M10 bracket inserts for landscape or portrait mounting, and 2 x M10 mounting points for yoke bracket inserts. The enclosure shall not exceed the following dimensions: 591 x 281 x 276 mm or 23.3 x 11.1 x 10.9" (H x W x D). The loudspeaker shall be the [TANNOY VX 8.2](#).

Install Speakers

VX 8.2-WH

8" Dual Concentric Full Range Loudspeaker
with Low Frequency Driver for Portable and
Installation Applications (White)

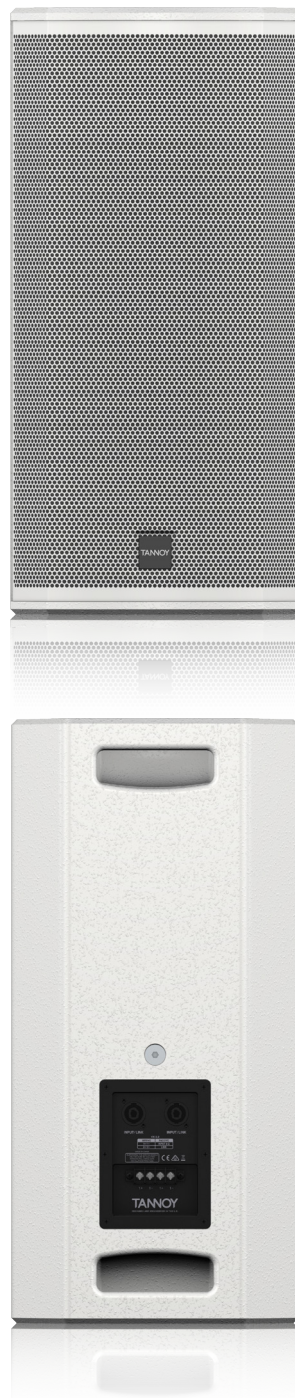

Install Speakers

VX 8.2-WH

8" Dual Concentric Full Range Loudspeaker
with Low Frequency Driver for Portable and
Installation Applications (White)

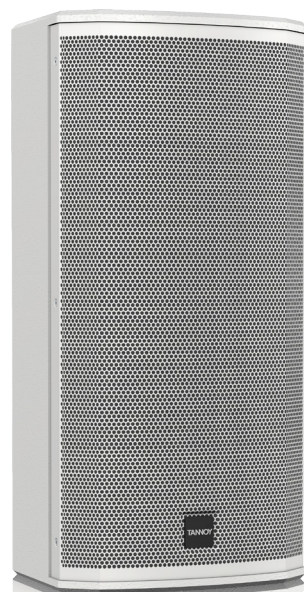

Install Speakers

VX 8.2-WH

8" Dual Concentric Full Range Loudspeaker
with Low Frequency Driver for Portable and
Installation Applications (White)

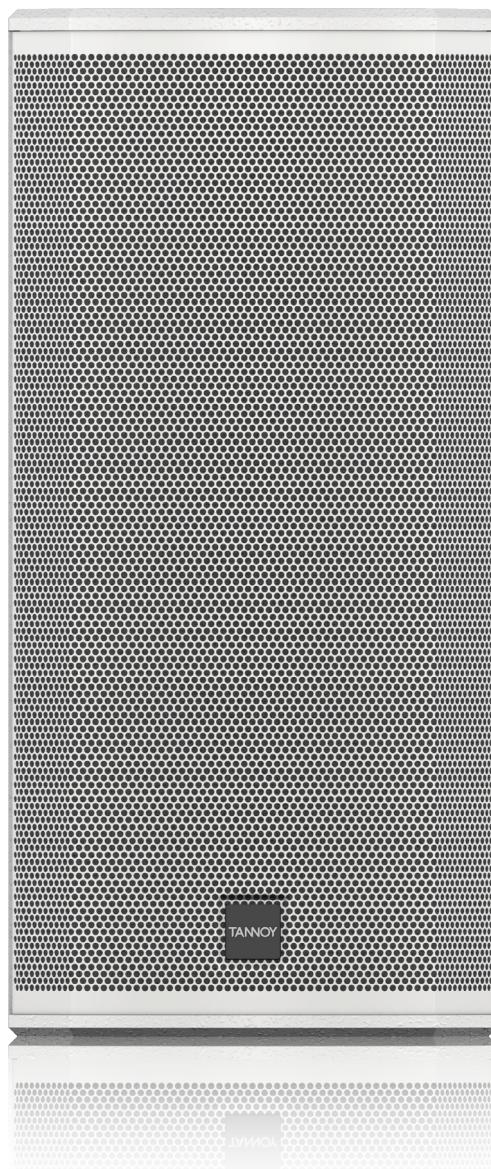

Install Speakers

VX 8.2-WH

8" Dual Concentric Full Range Loudspeaker
with Low Frequency Driver for Portable and
Installation Applications (White)

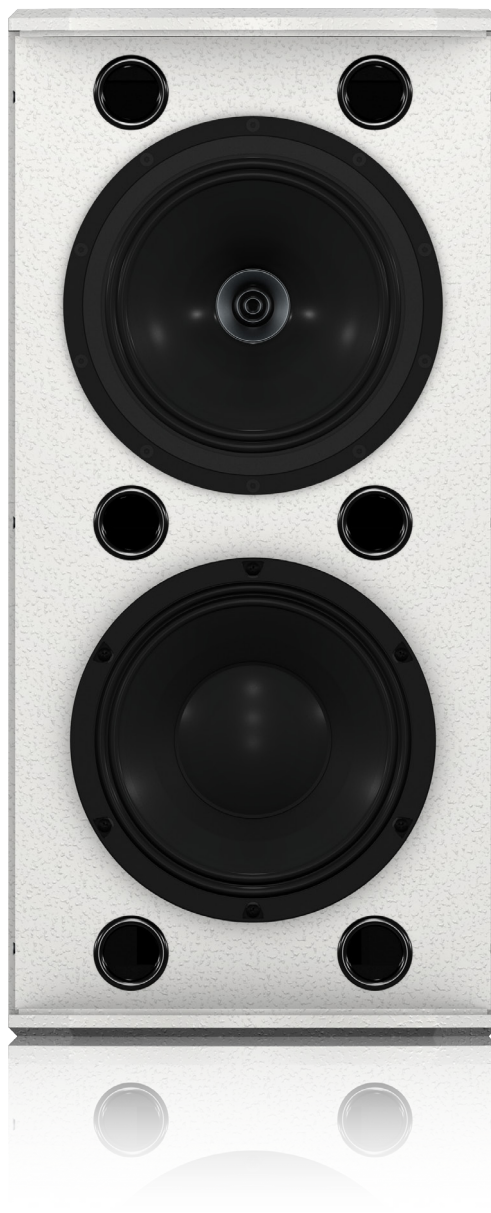

Install Speakers

VX 8.2-WH

8" Dual Concentric Full Range Loudspeaker
with Low Frequency Driver for Portable and
Installation Applications (White)



For service, support or more information contact the TANNOY location nearest you:

Europe
MUSIC Group Services UK
Tel: +44 1562 547 100
Email: CARE@music-group.com

USA/Canada
MUSIC Group Services NV Inc.
Tel: +1 702 963 1300
Email: CARE@music-group.com

Japan
MUSIC Group Services JP K.K.
Tel: +81 3 5833 9121
Email: CARE@music-group.com

MUSIC Group accepts no liability for any loss which may be suffered by any person who relies either wholly or in part upon any description, photograph, or statement contained herein. Technical specifications, appearances and other information are subject to change without notice. All trademarks are the property of their respective owners. MIDAS, KLARK TEKNIK, LAB GRUPPEN, LAKE, TANNOY, TURBOSOUND, TC ELECTRONIC, TC HELICON, BEHRINGER, BUGERA and DDA are trademarks or registered trademarks of MUSIC Group IP Ltd.
© MUSIC Group IP Ltd. 2017 All rights reserved.

TANNOY